

91038 BX3/IX3 filter cube (U-FF, U-M710) for Olympus BX3 and IX3

This guide provides step-by-step instructions for assembling a BX3/IX3 filter cube (U-FF, U-M710) for Olympus BX3 and IX3 (Chroma part number [91038](#)), designed for precise alignment of optical filters in fluorescence microscopy systems. Proper assembly ensures optimal performance and system reliability.

For those new to handling optical filters, we recommend reviewing our [Cleaning & Handling Instructions](#) before assembling your filter cube.

Required filter sizes

Exciter (x)	Ø25mm
Emitter (m)	Ø25mm
Beamsplitter	26 x 38 x 1mm

Required tools

- A flat, metal spanner tool is used to tighten the retaining rings. This tool comes with the cube.
- The halves can come apart with just your hands, but tweezers can also be used to push in the brass clips (seen on the side of the cube through a small notch), which releases the halves for separation.

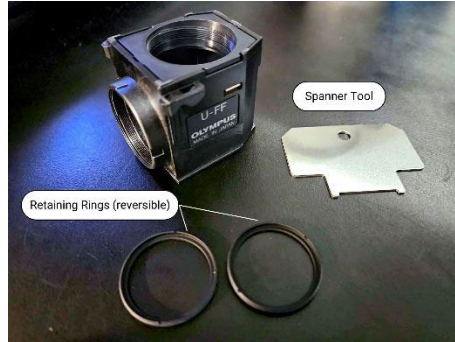

Step 1: The emitter holder can be removed by placing your finger in the emitter port and your thumb on the tab under it and pulling up. This position is depicted in the image.



Step 2: Place the cube half with the beam splitter holder on a flat surface. The beam splitter is gently dropped into the cube with the arrow on the side of the filter facing down.

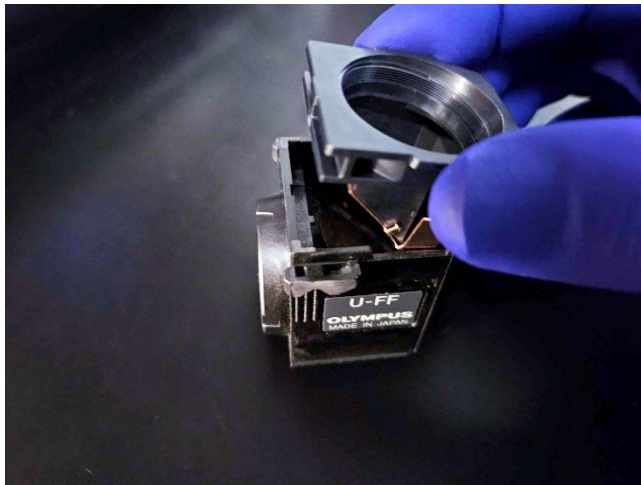

Step 3: Once the beam splitter is mounted, push the emitter mount into the cube until it clicks.



Step 4: Seat the emitter into the emitter port with the arrow facing in towards the beam splitter.

Screw in the retaining ring to secure the filter with the spanner tool.



Step 5: Place the exciter filter in the exciter port on the front of the cube with the arrow pointing in towards the beam splitter.

Screw in the retaining ring to secure the filter with the spanner tool.



Step 6: Fully assembled cube.