

## Mounting instructions Zeiss Axio Cube

This guide provides step-by-step instructions for assembling a Zeiss Axio filter cube (Chroma part number [91029](#)), designed for precise alignment of optical filters in fluorescence microscopy systems. Proper assembly ensures optimal performance and system reliability.

For those new to handling optical filters, we recommend reviewing our [Cleaning & Handling Instructions](#) before assembling your filter cube.

### Required filter sizes

|              |             |
|--------------|-------------|
| Exciter (x)  | Ø25mm       |
| Emitter (m)  | Ø25mm       |
| Beamsplitter | 25.5 × 36mm |

### Required tools

- Spanner tool to tighten the retaining rings. Note: If you don't have this tool, you can use tweezers once the ring has been seated, but be careful not to slip and mar the filter.

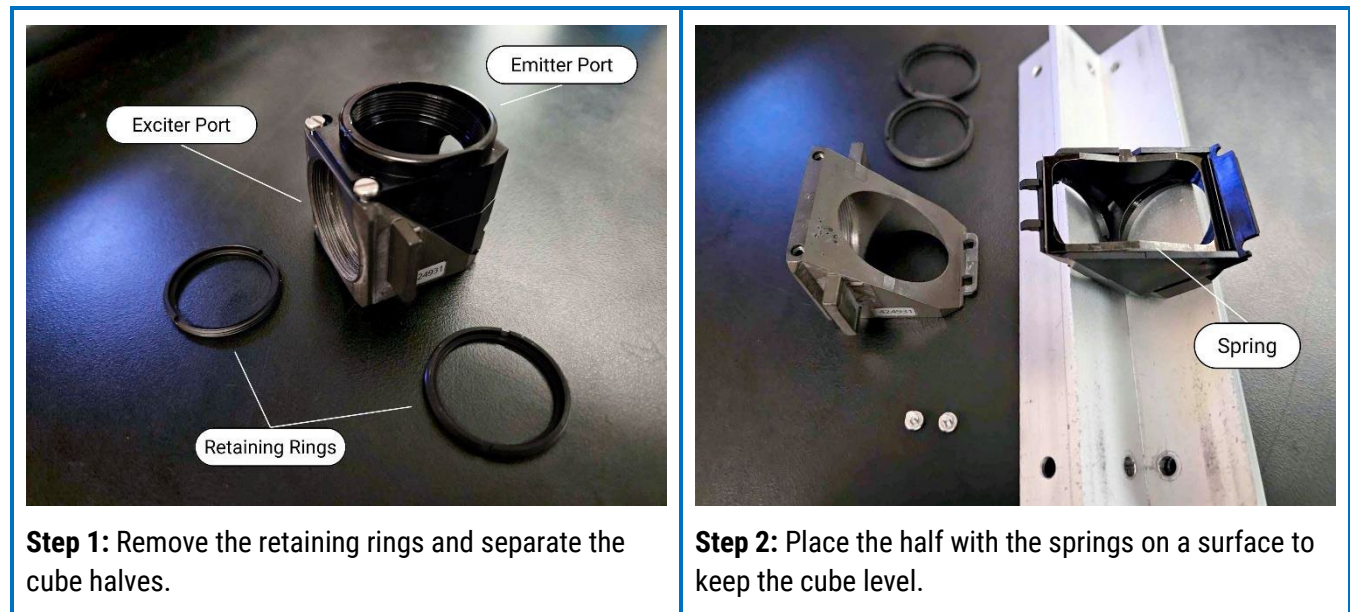

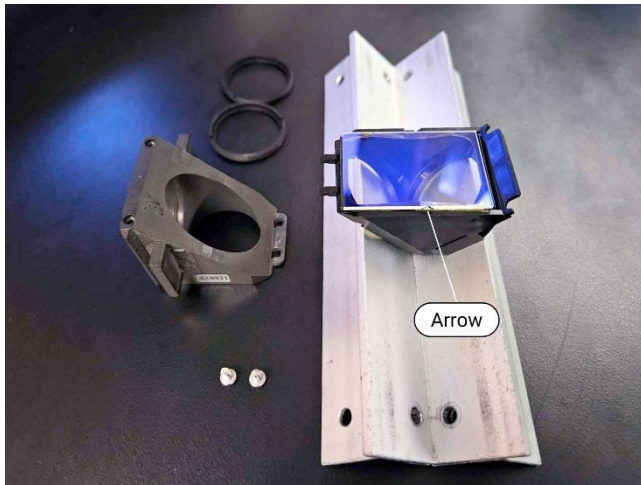

**Step 3:** Place the beam splitter on the cube half so it rests on the spring, with the arrow facing up. The arrow can be found on the side of the filter.

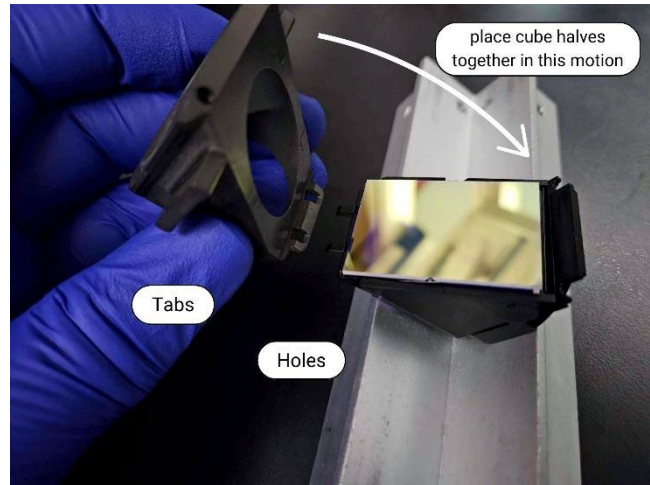

**Step 4:** Align the registration tabs and holes on both filters. Once tabs are aligned, move the cube half on top of the beam splitter so that the bottom holes slide over the bottom tabs. Once the halves are together, secure the cube together with screws.



**Step 5:** Place the exciter filter in the exciter port with the arrow facing in, towards the beam splitter. Screw the retaining ring in to secure the filter.



**Step 6:** Place the emitter filter into the emitter port with the arrow facing in, towards the beam splitter. Screw the retaining ring in to secure the filter.